

client
BIERBRIER DEVELOPMENT
 420 BEDFORD STREET
 LEXINGTON, MA 02420
 TEL# (781) 863-1800
 FAX# (781) 862-0613

engineers (civil)
Tighe & Bond
 177 Corporate Drive
 Portsmouth, NH 03801
 TEL# (603) 433-8818
 FAX# (603)

engineers (mep/fp)
C3
 313 Congress Street
 Boston, MA 02210
 TEL# (617) 330-9390
 FAX# (617) 330-9383

structural
Roome & Guarracino
 48 Grove Street
 Somerville, MA 02144
 TEL# (617) 628-1700
 FAX# (617) 628-1711

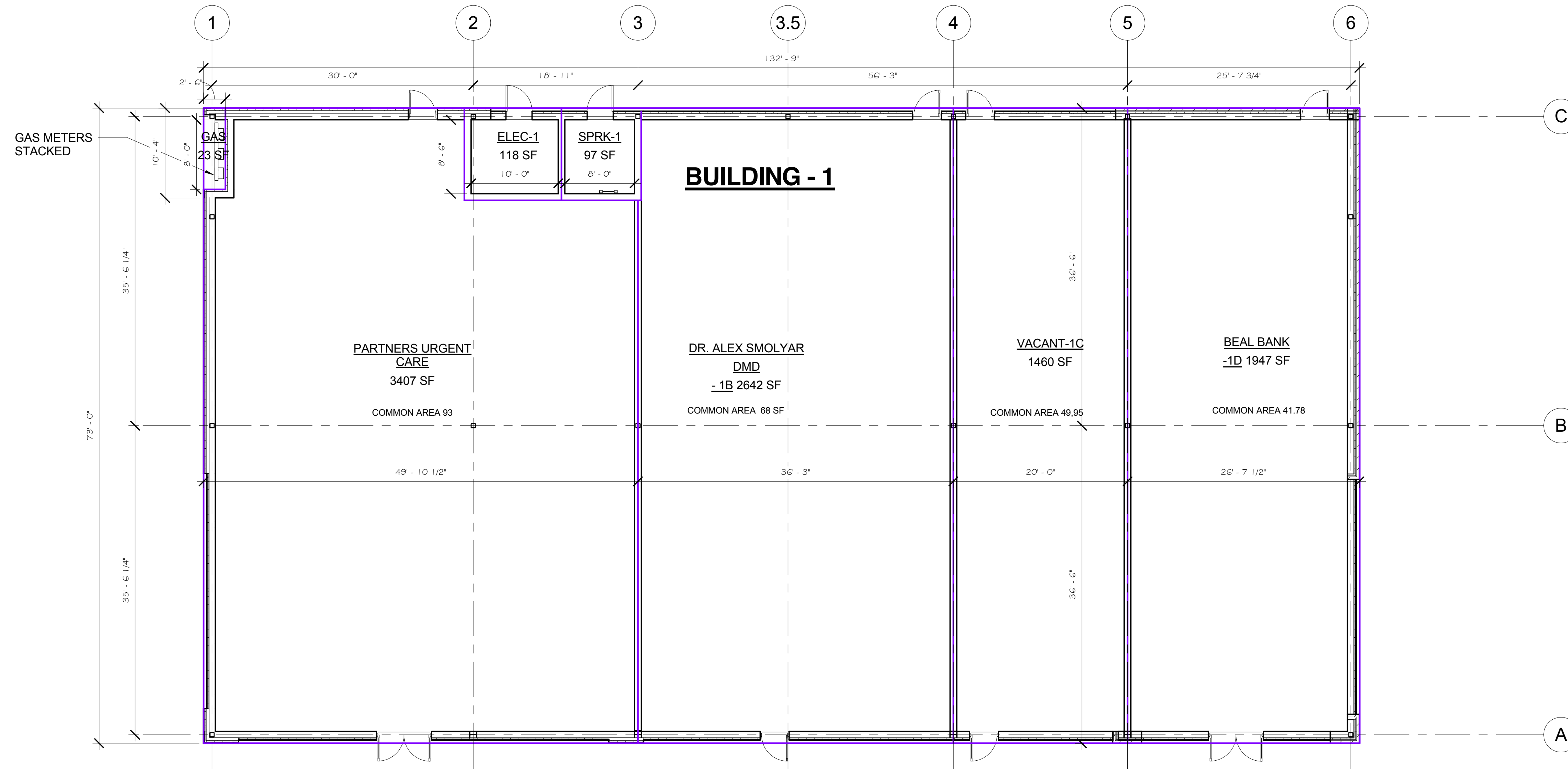

1 FIRST FLOOR LOD BUILDING 1
 1/8" = 1'-0"

Needham Street

71 Needham Street, Newton, MA 02461

Revisions:

02.20.2013	BID SET

Date: 04.02.2015
 Scale: 1/8" = 1'-0"
 Drawn by: SJB Checked by: DML
 Project: 11069.06

Title:
LOD PLAN

Drawing:
**ASK
 03**

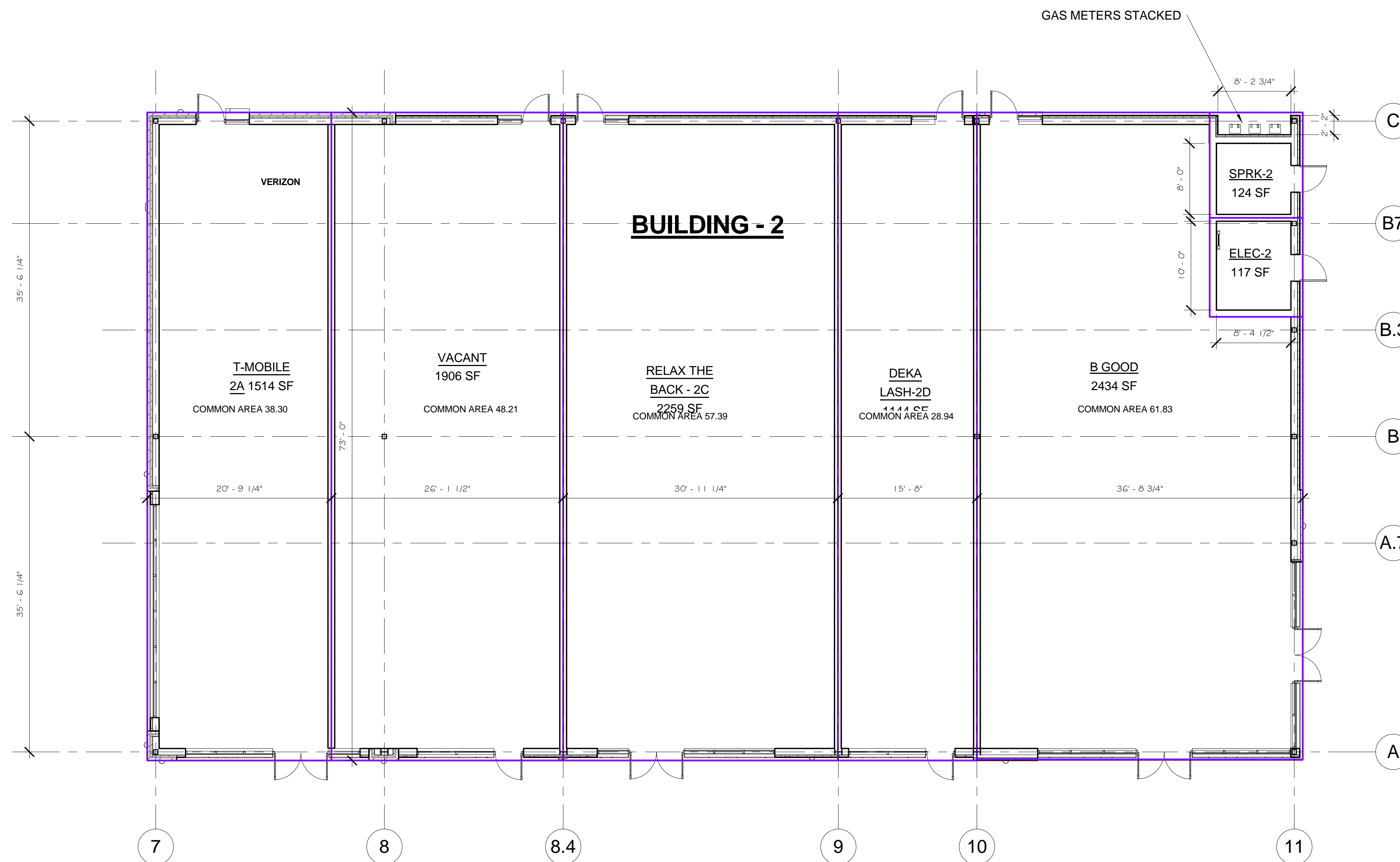

1 FIRST FLOOR LOD BUILDING 2
1/8" = 1'-0"

Needham Street

71 Needham Street, Newton, MA 02461

Revisions:	
02.20.2013	BID SET
01.09.15	LOD

Date: 05.05.2014
Scale: 1/8" = 1'-0"
Drawn by: Author Checked by: Checker
Project: 11069.01

Title:
LOD PLAN

Drawing:
**ASK
04**